

# ACTA-BACK® CONTOUR ORDER FORM



POSITIONING BACK, PLANAR WITH LATERAL SUPPORTS

Company Name/ACCT #: \_\_\_\_\_

P.O. Number: \_\_\_\_\_

Requested By: \_\_\_\_\_

Phone: \_\_\_\_\_ Fax: \_\_\_\_\_

Email: \_\_\_\_\_

Ship To: \_\_\_\_\_

Patient Reference: \_\_\_\_\_

ACTA BACK CONTOUR-LCS-NP-01/04/2017

If you would like an official quotation, please email completed form to [regina@lcseating.ie](mailto:regina@lcseating.ie), or fax 00353 71 9163918

If you have any queries, please contact the office on 00353 71 9163905



Shown with Compass® 4 Quick Release 2 Point Hardware.  
Cover appearance may vary with hardware selection.

## 1 SIZE SELECTION

Required

### Acta-Back® Contour 5

LENGTH*	22"				
	20"				
	18"				
	16"				
		16"	18"	20"	22" 24"
FRAME WIDTH					

Sizes available are subject to hardware being used.

ACTA-BACK® CONTOUR 5 PART NUMBER

**ABC5-BS** \_\_\_\_\_

### Acta-Back® Contour 8

LENGTH*	22"				
	20"				
	18"				
	16"				
		16"	18"	20"	22" 24"
FRAME WIDTH					

Sizes available are subject to hardware being used.

ACTA-BACK® CONTOUR 8 PART NUMBER

**ABC8-BS** \_\_\_\_\_

Please fill in one of the above part numbers with dimensions from the size charts to the right.

Example Part: **ABC5-BS18W16L**

Hardware will be selected in Section 2.

\*Length (L) refers to the actual size dimension of the support from bottom to top edge.

#### Sizes available with 2 POINT Hardware

LENGTH*	22"	16W22L	18W22L	20W22L	22W22L	
	20"	16W20L	18W20L	20W20L	22W20L	
	18"	16W18L	18W18L	20W18L	22W18L	
	16"	16W16L	18W16L	20W16L	22W16L	
		16"	18"	20"	22"	24"
FRAME WIDTH						

#### Sizes available with 4 POINT Hardware

LENGTH*	22"	16W22L	18W22L	20W22L	22W22L	24W22L
	20"	16W20L	18W20L	20W20L	22W20L	24W20L
	18"	16W18L	18W18L	20W18L	22W18L	24W18L
	16"	16W16L	18W16L	20W16L	22W16L	
		16"	18"	20"	22"	24"
FRAME WIDTH						

#### Sizes available with POWER Hardware

LENGTH*	22"	16W22L	18W22L	20W22L	22W22L	24W22L
	20"	16W20L	18W20L	20W20L	22W20L	24W20L
	18"	16W18L	18W18L	20W18L	22W18L	24W18L
	16"	16W16L	18W16L	20W16L	22W16L	
		16"	18"	20"	22"	24"
FRAME WIDTH						

# 2 COVER & HARDWARE SELECTION

Required

## 2.1 COVER SELECTION

Both fabrics are latex-free. Fabric selection is for the support surface only. Other fabrics used in cover construction remain the same.



**COMFORT-TEK™** is a smooth, easily cleaned surface. The fluid protection aids in infection control.



**STRETCH-AIR™** has comfortable stretch, air transmission and heat dissipation. It is not fluid resistant.

**COMFORT-TEK™ Cover**  
(COMFORT-TEK)

**STRETCH-AIR™ Cover**  
(STRETCH-AIR)

## 2.2 HARDWARE STYLE

### COMPASS® 4 QUICK RELEASE

Price included in back support purchase

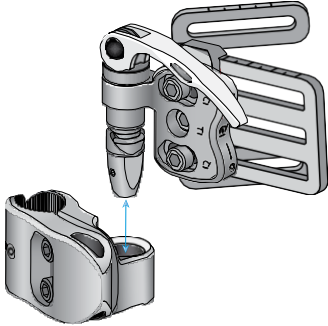

**QUICK RELEASE 2 POINT**  
(Q-COMPASS)

**QUICK RELEASE 4 POINT**  
(Q-COMPASS4)

**4 POINT** hardware is required on all 24"W back supports using Compass® 4 hardware.

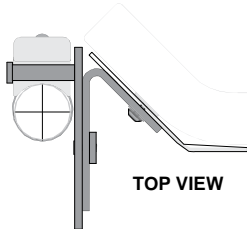

### COMPASS® 4 FIXED

Price included in back support purchase

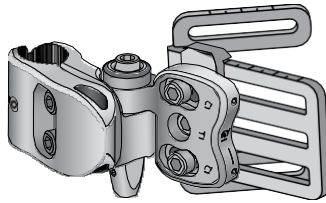

**FIXED** fully adjustable hardware requires tools for back support removal

**FIXED 2 POINT**  
(NQ-COMPASS)

**FIXED 4 POINT**  
(NQ-COMPASS4)

### COMPASS® POWER MOUNT

**UPCHARGE APPLIES**

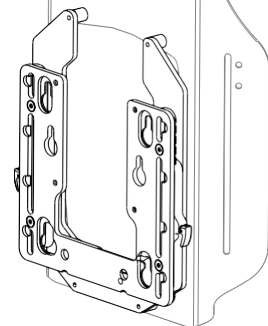

**POWER MOUNT** hardware has 8" of height adjustment in 1/2" increments without using tools.

**QUANTUM w/ TRU BALANCE 3**  
(PMB-QUANTUM)

**PERMOBIL w/ CORPUS 3G**  
(PMB-PERMOBIL)

**QUICKIE w/ 3.7 POWER**  
(PMB-QUICKIE)

**ROVI w/ MOTION CONCEPTS\***  
(PMB-ROVI)

**\*Using Power Mount Hardware on ROVI** requires mounting to the RECESSED PLANAR INTERFACE PLATE available when ordering the Motion Concepts Seating System. Drilling is required for mounting.

# 3 BACKSUPPORT ADD-ON SELECTIONS

Optional

## 3.1 COLOR UPCHARGE APPLIES

Accent colors are applied via colored piping. Placement of the piping may vary by back support size and mounting hardware. If no colors are selected, our standard silver reflective piping is used at no additional cost.



Color Location

	RED (AC-RED)
	PURPLE (AC-PURPLE)
	PINK (AC-PINK)
	BLUE (AC-BLUE)
	GREEN (AC-GREEN)
	REMOVE (AC-REMOVE)

## 3.2 EMBROIDERY UPCHARGE APPLIES

### A. THREAD COLOR OPTIONS

RED (EMB-RED)	BLUE (EMB-BLUE)
PURPLE (EMB-PURPLE)	GREEN (EMB-GREEN)
PINK (EMB-PINK)	SILVER (EMB-SILVER)

### B. FONT OPTIONS

Helvetica (EMB-Helvetica)	Twilight (EMB-Twilight)
Garamond (EMB-Garamond)	Script (EMB-Script)

### C. WORD ONE

WORD TWO (optional)

\*ADDITIONAL LEAD TIMES MAY APPLY

## 3.3 PRIVACY FLAP UPCHARGE APPLIES

This flap connects with hook & loop attachment between the seat and back for added privacy.

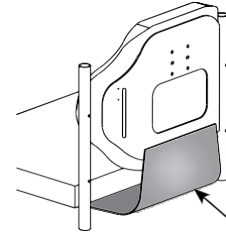

Privacy Flap







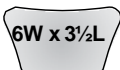

PRIVACY FLAP (PV-FLAP)

# 4 BODILINK HEAD SUPPORT & HARDWARE

Optional

## 4.1 HEAD SUPPORT PAD STYLE UPCHARGE APPLIES

Length (L) refers to the actual size dimension of the support from bottom to top edge.

W		Pad Firmness	
		Soft	BL-HSP1-6W3L
		Extra Soft	BL-HSP2-6W3L
		Soft	BL-HSP1-8W4L
		Extra Soft	BL-HSP2-8W4L
		Soft	BL-HSP1-10W5L
		Extra Soft	BL-HSP2-10W5L
		Soft	BL-HSP1-14W5L
		Extra Soft	BL-HSP2-14W5L
		Soft	BL-HSP1-18W5L
		Extra Soft	BL-HSP2-18W5L
W			

## 4.2 PAD COVER MATERIAL

	FOR SKIN PROTECTION & SHEAR REDUCTION. NOT FLUID RESISTANT.
	FOR FLUID PROTECTION & AN EASILY CLEANED SURFACE.
	FOR AIR TRANSMISSION & HEAT DISSIPATION.
	GlideWear® (GLIDEWEAR)
	Comfort-Tek (COMFORT-TEK)
	Stretch-Air (STRETCH-AIR)

4.3

HEAD SUPPORT HARDWARE
 

UPCHARGE APPLIES

