

ACTA-BACK® DEEP ORDER FORM



POSITIONING BACK, POSTERIOR LATERAL



Shown with Compass® 4 Quick Release 2 Point Hardware.
Cover appearance may vary with hardware selection.

This back support is also
available through
CID COMFORT
designs

Company Name/ACCT #: _____

P.O. Number: _____

Requested By: _____

Phone: _____ Fax: _____

Email: _____

Ship To: _____

Patient Reference: _____

ACTA BACK DEEP-LCS-NP-01/04/2017

If you would like an official quotation, please email completed form to
regina@lcseating.ie, or fax 00353 71 9163918

If you have any queries, please contact the office on 00353 71 9163905

1 SIZE SELECTION

Required

*Length (L) refers to the actual size dimension of the support from bottom to top edge.

Sizes available with 2 POINT Mounting Hardware

LENGTH *	22"		
	20"		
	18"		
	16"		
	14"		
	12"		
FRAME WIDTH			

Sizes available are subject to hardware being used.

3" DEEP WING PART NUMBER

ABD3-BS _____

5" DEEP WING PART NUMBER

ABD5-BS _____

7" DEEP WING PART NUMBER

ABD7-BS _____

12W14L	14W14L
12W12L	14W12L

Sizes not available with
7" Deep Wings.

Please fill in one of the above with dimensions
from the size charts to the right.
Example Part: **ABD5-BS14W16L**

Hardware will be selected in Section 2.

LENGTH*	22"		16W22L	18W22L	20W22L	22W22L
	20"	14W20L	16W20L	18W20L	20W20L	22W20L
	18"	12W18L	14W18L	16W18L	18W18L	20W18L
	16"	12W16L	14W16L	16W16L	18W16L	20W16L
	14"	12W14L	14W14L	16W14L	18W14L	20W14L
	12"	12W12L	14W12L	16W12L	18W12L	
FRAME WIDTH						

LENGTH*	22"		16W22L	18W22L	20W22L	22W22L	24W22L
	20"	14W20L	16W20L	18W20L	20W20L	22W20L	24W20L
	18"	12W18L	14W18L	16W18L	18W18L	20W18L	22W18L
	16"	12W16L	14W16L	16W16L	18W16L	20W16L	22W16L
	14"	12W14L	14W14L	16W14L	18W14L	20W14L	
	12"						
FRAME WIDTH							

LENGTH*	22"		16W22L	18W22L	20W22L	22W22L	24W22L
	20"	14W20L	16W20L	18W20L	20W20L	22W20L	24W20L
	18"		14W18L	16W18L	18W18L	20W18L	22W18L
	16"		14W16L	16W16L	18W16L	20W16L	22W16L
	14"	12W14L	14W14L	16W14L	18W14L	20W14L	
	12"	12W12L	14W12L	16W12L	18W12L		
FRAME WIDTH							

2 COVER & HARDWARE SELECTION

Required

2.1 COVER SELECTION

Both fabrics are latex-free. Fabric selection is for the support surface only. Other fabrics used in cover construction remain the same.



COMFORT-TEK™ is a smooth, easily cleaned surface. The fluid protection aids in infection control.



STRETCH-AIR™ has comfortable stretch, air transmission and heat dissipation. It is not fluid resistant.

COMFORT-TEK™ Cover
(COMFORT-TEK)

STRETCH-AIR™ Cover
(STRETCH-AIR)

2.2 HARDWARE STYLE

COMPASS® 4 QUICK RELEASE

Price included in back support purchase

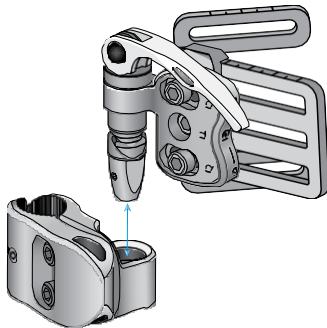

QUICK RELEASE 2 POINT
(Q-COMPASS)

QUICK RELEASE 4 POINT
(Q-COMPASS4)

4 POINT hardware is required on all 24"W back supports using Compass® 4 hardware.

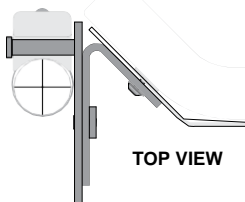

COMPASS® 4 FIXED

Price included in back support purchase

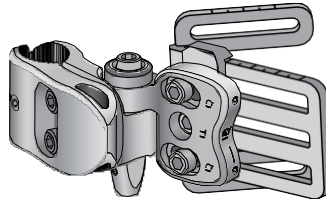

FIXED fully adjustable hardware requires tools for back support removal

FIXED 2 POINT
(NQ-COMPASS)

FIXED 4 POINT
(NQ-COMPASS4)

COMPASS® POWER MOUNT

UPCHARGE APPLIES

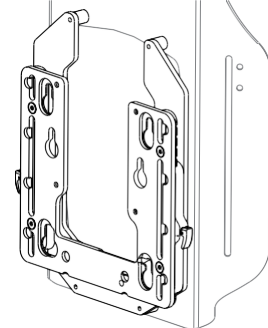

POWER MOUNT hardware has 8" of height adjustment in 1/2" increments without using tools.

QUANTUM w/ TRU BALANCE 3
(PMB-QUANTUM)

PERMOBIL w/ CORPUS 3G
(PMB-PERMOBIL)

QUICKIE w/ 3.7 POWER
(PMB-QUICKIE)

ROVI w/ MOTION CONCEPTS*
(PMB-ROVI)

***Using Power Mount Hardware on ROVI** requires mounting to the RECESSED PLANAR INTERFACE PLATE available when ordering the Motion Concepts Seating System. Drilling is required for mounting.

3 BACKSUPPORT ADD-ON SELECTIONS

Optional

3.1 COLOR

UPCHARGE APPLIES

Accent colors are applied via colored piping. Placement of the piping may vary by back support size and mounting hardware. If no colors are selected, our standard silver reflective piping is used at no additional cost.



Color Location

	RED (AC-RED)
	PURPLE (AC-PURPLE)
	PINK (AC-PINK)
	BLUE (AC-BLUE)
	GREEN (AC-GREEN)
	REMOVE (AC-REMOVE)

3.2 EMBROIDERY

UPCHARGE APPLIES

A. THREAD COLOR OPTIONS

RED (EMB-RED)	BLUE (EMB-BLUE)
PURPLE (EMB-PURPLE)	GREEN (EMB-GREEN)
PINK (EMB-PINK)	SILVER (EMB-SILVER)

B. FONT OPTIONS

Helvetica (EMB-Helvetica)	Twilight (EMB-Twilight)
Garamond (EMB-Garamond)	Script (EMB-Script)

C. WORD ONE

WORD TWO (optional)

*ADDITIONAL LEAD TIMES MAY APPLY

3.3 PRIVACY FLAP

UPCHARGE APPLIES

This flap connects with hook & loop attachment between the seat and back for added privacy.

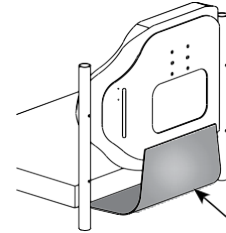

Privacy Flap

PRIVACY FLAP (PV-FLAP)







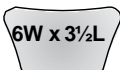

4 BODILINK HEAD SUPPORT & HARDWARE

Optional

4.1 HEAD SUPPORT PAD STYLE

UPCHARGE APPLIES

Length (L) refers to the actual size dimension of the support from bottom to top edge.

W		Pad Firmness	
		Soft	BL-HSP1-6W3L
		Extra Soft	BL-HSP2-6W3L
		Soft	BL-HSP1-8W4L
		Extra Soft	BL-HSP2-8W4L
		Soft	BL-HSP1-10W5L
		Extra Soft	BL-HSP2-10W5L
		Soft	BL-HSP1-14W5L
		Extra Soft	BL-HSP2-14W5L
		Soft	BL-HSP1-18W5L
		Extra Soft	BL-HSP2-18W5L
W			

4.2 PAD COVER MATERIAL

	FOR SKIN PROTECTION & SHEAR REDUCTION. NOT FLUID RESISTANT.
	FOR FLUID PROTECTION & AN EASILY CLEANED SURFACE.
	FOR AIR TRANSMISSION & HEAT DISSIPATION.
	GlideWear® (GLIDEWEAR)
	Comfort-Tek (COMFORT-TEK)
	Stretch-Air (STRETCH-AIR)

4.3

HEAD SUPPORT HARDWARE

UPCHARGE APPLIES

