

ACTA-BACK® ORDER FORM



POSITIONING BACK



Shown with Compass® 4 Quick Release 2 Point Hardware.
Cover appearance may vary with hardware selection.

This back support is also
available through
CID COMFORT
designs

Company Name/ACCT #: _____

P.O. Number: _____

Requested By: _____

Phone: _____ Fax: _____

Email: _____

Ship To: _____

Patient Reference: _____

ACTA BACK-LCS-NP-01/04/2017

If you would like an official quotation, please email completed form to
regina@lcseating.ie, or fax 00353 71 9163918

If you have any queries, please contact the office on 00353 71 9163905

1 SIZE SELECTION Required

*Length (L) refers to the actual size dimension of the support from bottom to top edge.

Sizes available with 2 POINT Mounting Hardware

LENGTH*	22"	20"	18"	16"	14"	12"	10"
FRAME WIDTH							
	12"	14"	16"	18"	20"	22"	24"

Sizes available are subject to hardware being used.

LENGTH*	22"	20"	18"	16"	14"	12"	10"
FRAME WIDTH							
	12"	14"	16"	18"	20"	22"	24"

Sizes available with 4 POINT Mounting Hardware

LENGTH*	22"	20"	18"	16"	14"	12"	10"
FRAME WIDTH							
	12"	14"	16"	18"	20"	22"	24"

Sizes available with POWER Mounting Hardware

LENGTH*	22"	20"	18"	16"	14"	12"	10"
FRAME WIDTH							
	12"	14"	16"	18"	20"	22"	24"

AB-BS

Please fill in the above with dimensions
from the size charts to the right.

Example Part: **AB-BS14W16L**

Hardware will be selected in Section 2.

2 COVER & HARDWARE SELECTION

Required

2.1 COVER SELECTION

Both fabrics are latex-free. Fabric selection is for the support surface only. Other fabrics used in cover construction remain the same.



COMFORT-TEK™ is a smooth, easily cleaned surface. The fluid protection aids in infection control.



STRETCH-AIR™ has comfortable stretch, air transmission and heat dissipation. It is not fluid resistant.

COMFORT-TEK™ Cover
(COMFORT-TEK)

STRETCH-AIR™ Cover
(STRETCH-AIR)

2.2 HARDWARE STYLE

COMPASS® 4 QUICK RELEASE

Price included in back support purchase

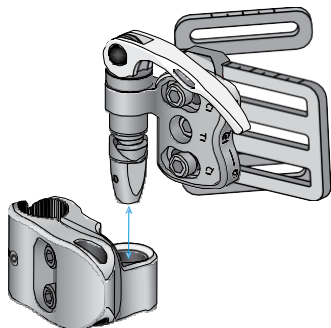

QUICK RELEASE 2 POINT
(Q-COMPASS)

QUICK RELEASE 4 POINT
(Q-COMPASS4)

4 POINT hardware is required on all 24"W back supports using Compass® 4 hardware.

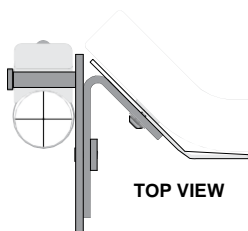

COMPASS® 4 FIXED

Price included in back support purchase

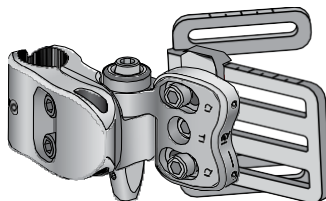

FIXED fully adjustable hardware requires tools for back support removal

FIXED 2 POINT
(NQ-COMPASS)

FIXED 4 POINT
(NQ-COMPASS4)

COMPASS® POWER MOUNT

UPCHARGE APPLIES

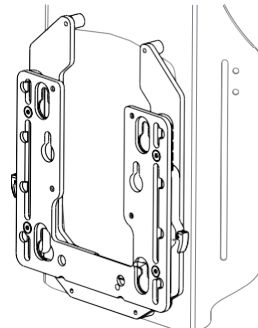

POWER MOUNT hardware has 8" of height adjustment in 1/2" increments without using tools.

QUANTUM w/ TRU BALANCE 3
(PMB-QUANTUM)

PERMOBIL w/ CORPUS 3G
(PMB-PERMOBIL)

QUICKIE w/ 3.7 POWER
(PMB-QUICKIE)

ROVI w/ MOTION CONCEPTS*
(PMB-ROVI)

*Using Power Mount Hardware on ROVI requires mounting to the RECESSED PLANAR INTERFACE PLATE available when ordering the Motion Concepts Seating System. Drilling is required for mounting.

3 BACKSUPPORT ADD-ON SELECTIONS

Optional

3.1 COLOR UPCHARGE APPLIES

Accent colors are applied via colored piping. Placement of the piping may vary by back support size and mounting hardware. If no colors are selected, our standard silver reflective piping is used at no additional cost.



Color Location

	RED (AC-RED)
	PURPLE (AC-PURPLE)
	PINK (AC-PINK)
	BLUE (AC-BLUE)
	GREEN (AC-GREEN)
	REMOVE (AC-REMOVE)

3.2 EMBROIDERY UPCHARGE APPLIES

A. THREAD COLOR OPTIONS

RED (EMB-RED)	BLUE (EMB-BLUE)
PURPLE (EMB-PURPLE)	GREEN (EMB-GREEN)
PINK (EMB-PINK)	SILVER (EMB-SILVER)

B. FONT OPTIONS

Helvetica (EMB-Helvetica)	Twilight (EMB-Twilight)
Garamond (EMB-Garamond)	Script (EMB-Script)

C. WORD ONE

WORD TWO (optional)

*ADDITIONAL LEAD TIMES MAY APPLY

3.3 PRIVACY FLAP UPCHARGE APPLIES

This flap connects with hook & loop attachment between the seat and back for added privacy.

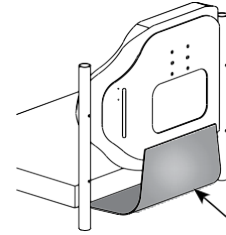

Privacy Flap

PRIVACY FLAP (PV-FLAP)

COMFORT-TEK™
is a smooth, easily cleaned surface. The fluid protection aids in infection control.

STRETCH-AIR™
has comfortable stretch, air transmission and heat dissipation.

4 LATERAL TRUNK SUPPORT & HARDWARE

Optional

4.1 LATERAL TRUNK SUPPORT PAD STYLE UPCHARGE APPLIES

- Select a left and/or right lateral trunk support pad using any combination of size, style and fabric.

*Length (L) refers to the actual size dimension of the support from top to bottom edge.

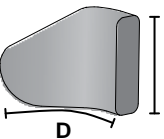
		4"D x 3"L		5"D x 3"L		5"D x 4"L		6"D x 4"L		6"D x 6"L		7"D x 5"L	
MOLDABLE 	COMFORT-TEK	LT1-MF4W3T		LT1-MF5W3T		LT1-MF5W4T		LT1-MF6W4T		LT1-MF6W6T		LT1-MF7W5T	
		Left	Right	Left	Right	Left	Right	Left	Right	Left	Right	Left	Right
		Extra Left	Extra Right	Extra Left	Extra Right	Extra Left	Extra Right	Extra Left	Extra Right	Extra Left	Extra Right	Extra Left	Extra Right
	STRETCH-AIR	LT1-MS4W3T		LT1-MS5W3T		LT1-MS5W4T		LT1-MS6W4T		LT1-MS6W6T		LT1-MS7W5T	
MOLDABLE ACTIVE 	COMFORT-TEK	LT1-MF4W3T-AL	LT1-MF4W3T-AR	LT1-MF5W3T-AL	LT1-MF5W3T-AR	LT1-MF5W4T-AL	LT1-MF5W4T-AR	LT1-MF6W4T-AL	LT1-MF6W4T-AR	LT1-MF6W6T-AL	LT1-MF6W6T-AR	LT1-MF7W5T-AL	LT1-MF7W5T-AR
		Left	Right	Left	Right	Left	Right	Left	Right	Left	Right	Left	Right
		Extra Left	Extra Right	Extra Left	Extra Right	Extra Left	Extra Right	Extra Left	Extra Right	Extra Left	Extra Right	Extra Left	Extra Right
	STRETCH-AIR	LT1-MS4W3T-AL	LT1-MS4W3T-AR	LT1-MS5W3T-AL	LT1-MS5W3T-AR	LT1-MS5W4T-AL	LT1-MS5W4T-AR	LT1-MS6W4T-AL	LT1-MS6W4T-AR	LT1-MS6W6T-AL	LT1-MS6W6T-AR	LT1-MS7W5T-AL	LT1-MS7W5T-AR
RIGID 	COMFORT-TEK	LT1-RF4W3T		LT1-RF5W3T		LT1-RF5W4T		LT1-RF6W4T		LT1-RF6W6T		LT1-RF7W5T	
		Left	Right	Left	Right	Left	Right	Left	Right	Left	Right	Left	Right
		Extra Left	Extra Right	Extra Left	Extra Right	Extra Left	Extra Right	Extra Left	Extra Right	Extra Left	Extra Right	Extra Left	Extra Right
	STRETCH-AIR	LT1-RS4W3T		LT1-RS5W3T		LT1-RS5W4T		LT1-RS6W4T		LT1-RS6W6T		LT1-RS7W5T	
RIGID ACTIVE 	COMFORT-TEK	LT1-RF4W3T-AL	LT1-RF4W3T-AR	LT1-RF5W3T-AL	LT1-RF5W3T-AR	LT1-RF5W4T-AL	LT1-RF5W4T-AR	LT1-RF6W4T-AL	LT1-RF6W4T-AR	LT1-RF6W6T-AL	LT1-RF6W6T-AR	LT1-RF7W5T-AL	LT1-RF7W5T-AR
		Left	Right	Left	Right	Left	Right	Left	Right	Left	Right	Left	Right
		Extra Left	Extra Right	Extra Left	Extra Right	Extra Left	Extra Right	Extra Left	Extra Right	Extra Left	Extra Right	Extra Left	Extra Right
	STRETCH-AIR	LT1-RS4W3T-AL	LT1-RS4W3T-AR	LT1-RS5W3T-AL	LT1-RS5W3T-AR	LT1-RS5W4T-AL	LT1-RS5W4T-AR	LT1-RS6W4T-AL	LT1-RS6W4T-AR	LT1-RS6W6T-AL	LT1-RS6W6T-AR	LT1-RS7W5T-AL	LT1-RS7W5T-AR
		Left	Right	Left	Right	Left	Right	Left	Right	Left	Right	Left	Right
		Extra Left	Extra Right	Extra Left	Extra Right	Extra Left	Extra Right	Extra Left	Extra Right	Extra Left	Extra Right	Extra Left	Extra Right

4 LATERAL TRUNK SUPPORT & HARDWARE Continued

Optional

4.2 LATERAL TRUNK SUPPORT HARDWARE

Select a set of hardware below (Section A). Extra links (Section B) may be selected to add 1" of additional depth and adjustability.

A) SWING-AWAY

UPCHARGE APPLIES

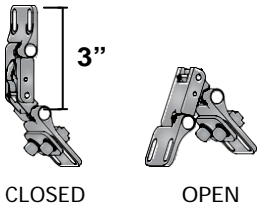

LTL-SF		LTR-SF	
	Left		Right
	Extra Left		Extra Right

RIGID

UPCHARGE APPLIES



LTL-RF		LTR-RF	
	Left		Right
	Extra Left		Extra Right

B) EXTRA LINKS

UPCHARGE APPLIES

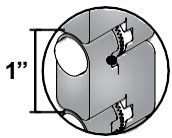

LEFT	LT1-LINK	RIGHT	LT1-LINK
	1 Extra Link		1 Extra Link
	2 Extra Links		2 Extra Links
	3 Extra Links		3 Extra Links
	4 Extra Links		4 Extra Links

Both hardware styles in Section A are width adjustable.

4.3 PROTECTIVE COVER (OPTIONAL)

PROTECTIVE LATERAL HARDWARE COVER

UPCHARGE APPLIES

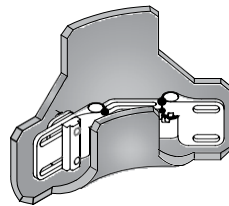

LT1-PROTECT2			
	Left		Right
	Extra Left		Extra Right

Cover wraps around hardware and closes with hook and loop attachment.

5 BODILINK HEAD SUPPORT & HARDWARE

Optional

5.1 HEAD SUPPORT PAD STYLE

UPCHARGE APPLIES

Length (L) refers to the actual size dimension of the support from bottom to top edge.

W		Pad Firmness	
L	6W x 3½L	Soft	BL-HSP1-6W3L
		Extra Soft	BL-HSP2-6W3L
L	8W x 4L	Soft	BL-HSP1-8W4L
		Extra Soft	BL-HSP2-8W4L
L	10W x 5L with adjustable wings	Soft	BL-HSP1-10W5L
		Extra Soft	BL-HSP2-10W5L
L	14W x 5L with adjustable wings	Soft	BL-HSP1-14W5L
		Extra Soft	BL-HSP2-14W5L
L	18W x 5L with adjustable wings	Soft	BL-HSP1-18W5L
		Extra Soft	BL-HSP2-18W5L
W			

5.2 PAD COVER MATERIAL

 COMFORT-TEK  STRETCH-AIR 	FOR SKIN PROTECTION & SHEAR REDUCTION. NOT FLUID RESISTANT.
	FOR FLUID PROTECTION & AN EASILY CLEANED SURFACE.
	FOR AIR TRANSMISSION & HEAT DISSIPATION.
	GlideWear® (GLIDEWEAR)
	Comfort-Tek (COMFORT-TEK)
	Stretch-Air (STRETCH-AIR)

5.3

HEAD SUPPORT HARDWARE

UPCHARGE APPLIES

