

ACTA-RELIEF™ ORDER FORM



POSITIONING BACK, POSTERIOR LATERAL

Acta-Relief Patent Pending



Shown with Compass® 4 Quick Release 2 Point Hardware.
Cover appearance may vary with hardware selection.

This back support is also
available through
CID COMFORT
designs

Company Name/ACCT #: _____

P.O. Number: _____

Requested By: _____

Phone: _____ Fax: _____

Email: _____

Ship To: _____

Patient Reference: _____

ACTA RELIEF-LCS-NP-01/04/2017

If you would like an official quotation, please email completed form to
regina@lcseating.ie, or fax 00353 71 9163918

If you have any queries, please contact the office on 00353 71 9163905

1 SIZE SELECTION Required

*Length (L) refers to the actual size dimension of the support from bottom to top edge.

Sizes available with 2 POINT Mounting Hardware

LENGTH*	22"				
	20"				
	18"				
	16"				
	14"				
	12"				
	10"				
		14"	16"	18"	20"
		FRAME WIDTH			

Sizes available are subject to hardware being used.

LENGTH*	22"	14W22L	16W22L	18W22L	20W22L
	20"	14W20L	16W20L	18W20L	20W20L
	18"	14W18L	16W18L	18W18L	20W18L
	16"	14W16L	16W16L	18W16L	20W16L
	14"	14W14L	16W14L	18W14L	20W14L
	12"	14W12L	16W12L	18W12L	20W12L
	10"	14W10L	16W10L	18W10L	20W10L
		14"	16"	18"	20"
		FRAME WIDTH			

Sizes available with 4 POINT Mounting Hardware

LENGTH*	22"	14W22L	16W22L	18W22L	20W22L
	20"	14W20L	16W20L	18W20L	20W20L
	18"	14W18L	16W18L	18W18L	20W18L
	16"	14W16L	16W16L	18W16L	20W16L
	14"	14W14L	16W14L	18W14L	20W14L
	12"	14W12L	16W12L	18W12L	20W12L
	10"				
		14"	16"	18"	20"
		FRAME WIDTH			

AR-BS

Please fill in one of the above with dimensions
from the size charts to the right.

Example Part: **AR-BS14W16L**

Hardware will be selected in Section 2.

14W10L	16W10L	18W10L	20W10L
--------	--------	--------	--------

Please note these sizes are not available with
lateral trunk supports or a head support.

14W12L	16W12L	18W12L	20W12L
--------	--------	--------	--------

Please note these sizes are not available with
4 POINT when using lateral trunk supports.

Sizes available with POWER Mounting Hardware

LENGTH*	22"	14W22L	16W22L	18W22L	20W22L
	20"	14W20L	16W20L	18W20L	20W20L
	18"	14W18L	16W18L	18W18L	20W18L
	16"	14W16L	16W16L	18W16L	20W16L
	14"	14W14L	16W14L	18W14L	20W14L
	12"	14W12L	16W12L	18W12L	20W12L
	10"				
		14"	16"	18"	20"
		FRAME WIDTH			

2 COVER & HARDWARE SELECTION

Required

2.1 COVER SELECTION

Both fabrics are latex-free. Fabric selection is for the support surface only. Other fabrics used in cover construction remain the same.



COMFORT-TEK™ is a smooth, easily cleaned surface. The fluid protection aids in infection control.



STRETCH-AIR™ has comfortable stretch, air transmission and heat dissipation. It is not fluid resistant.

COMFORT-TEK™ Cover
(COMFORT-TEK)

STRETCH-AIR™ Cover
(STRETCH-AIR)

2.2 HARDWARE STYLE

COMPASS® 4 QUICK RELEASE

Price included in back support purchase

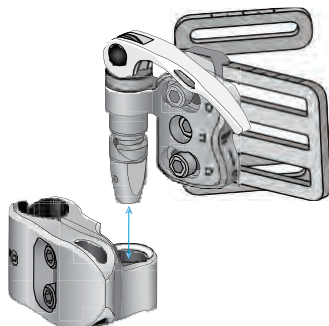

QUICK RELEASE 2 POINT
(Q-COMPASS)

QUICK RELEASE 4 POINT
(Q-COMPASS4)

4 POINT hardware is required on all 24"W back supports using Compass® 4 hardware.

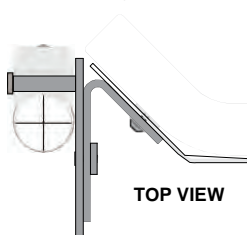

COMPASS® 4 FIXED

Price included in back support purchase

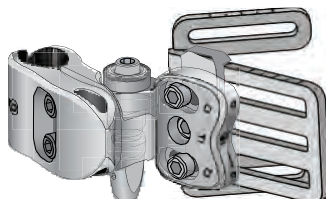

FIXED fully adjustable hardware requires tools for back support removal

FIXED 2 POINT
(NQ-COMPASS)

FIXED 4 POINT
(NQ-COMPASS4)

COMPASS® POWER MOUNT

UPCHARGE APPLIES

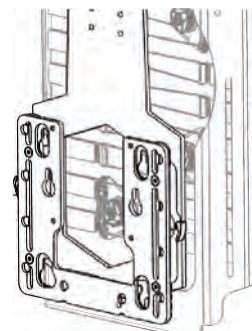

POWER MOUNT hardware has 8" of height adjustment in ½" increments without using tools.

QUANTUM w/ TRU BALANCE 3
(PMB-QUANTUM)

PERMOBIL w/ CORPUS 3G
(PMB-PERMOBIL)

QUICKIE w/ 3.7 POWER
(PMB-QUICKIE)

ROVI w/ MOTION CONCEPTS*
(PMB-ROVI)

*Using Power Mount Hardware on ROVI requires mounting to the RECESSED PLANAR INTERFACE PLATE available when ordering the Motion Concepts Seating System. Drilling is required for mounting.

3 BACKSUPPORT ADD-ON SELECTIONS

Optional

3.1 COLOR

UPCHARGE APPLIES

Accent colors are applied via colored piping. Placement of the piping may vary by back support size and mounting hardware. If no colors are selected, our standard silver reflective piping is used at no additional cost.



Color Location

	RED (AC-RED)
	PURPLE (AC-PURPLE)
	PINK (AC-PINK)
	BLUE (AC-BLUE)
	GREEN (AC-GREEN)
	REMOVE (AC-REMOVE)

3.2 EMBROIDERY

UPCHARGE APPLIES

A. THREAD COLOR OPTIONS

RED (EMB-RED)	BLUE (EMB-BLUE)
PURPLE (EMB-PURPLE)	GREEN (EMB-GREEN)
PINK (EMB-PINK)	SILVER (EMB-SILVER)

B. FONT OPTIONS

Helvetica (EMB-Helvetica)	Twilight (EMB-Twilight)
Garamond (EMB-Garamond)	Script (EMB-Script)

C. WORD ONE

WORD TWO (optional)

*ADDITIONAL LEAD TIMES MAY APPLY

3.3 PRIVACY FLAP

UPCHARGE APPLIES

This flap connects with hook & loop attachment between the seat and back for added privacy.

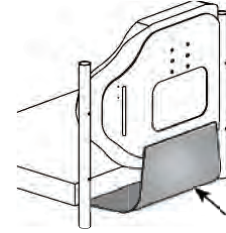

Privacy Flap

PRIVACY FLAP (PV-FLAP)

COMFORT-TEK™
is a smooth, easily cleaned surface. The fluid protection aids in infection control.

STRETCH-AIR™
has comfortable stretch, air transmission and heat dissipation.

4 LATERAL TRUNK SUPPORT & HARDWARE

Optional

4.1 LATERAL TRUNK SUPPORT PAD STYLE

UPCHARGE APPLIES

Select a left and/or right lateral trunk support pad using any combination of size, style and fabric.

*Length (L) refers to the actual size dimension of the support from top to bottom edge.

Lateral Trunk Supports not available for 10"L Back Supports

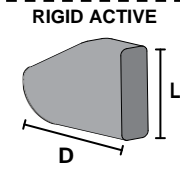
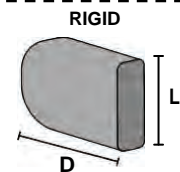
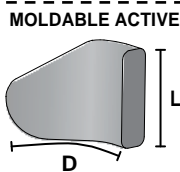
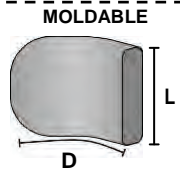

		4"D x 3"L		5"D x 3"L		5"D x 4"L		6"D x 4"L		6"D x 6"L		7"D x 5"L	
COMFORT-TEK	LT1-MF4W3T	Left	Right	Left	Right	Left	Right	Left	Right	Left	Right	Left	Right
		Extra Left	Extra Right	Extra Left	Extra Right	Extra Left	Extra Right	Extra Left	Extra Right	Extra Left	Extra Right	Extra Left	Extra Right
	LT1-MF5W3T	Left	Right	Left	Right	Left	Right	Left	Right	Left	Right	Left	Right
		Extra Left	Extra Right	Extra Left	Extra Right	Extra Left	Extra Right	Extra Left	Extra Right	Extra Left	Extra Right	Extra Left	Extra Right
STRETCH-AIR	LT1-MS4W3T	Left	Right	Left	Right	Left	Right	Left	Right	Left	Right	Left	Right
		Extra Left	Extra Right	Extra Left	Extra Right	Extra Left	Extra Right	Extra Left	Extra Right	Extra Left	Extra Right	Extra Left	Extra Right
	LT1-MS5W3T	Left	Right	Left	Right	Left	Right	Left	Right	Left	Right	Left	Right
		Extra Left	Extra Right	Extra Left	Extra Right	Extra Left	Extra Right	Extra Left	Extra Right	Extra Left	Extra Right	Extra Left	Extra Right
COMFORT-TEK	LT1-MF4W3T-AL	Left	Right	Left	Right	Left	Right	Left	Right	Left	Right	Left	Right
		Extra Left	Extra Right	Extra Left	Extra Right	Extra Left	Extra Right	Extra Left	Extra Right	Extra Left	Extra Right	Extra Left	Extra Right
	LT1-MF5W3T-AL	Left	Right	Left	Right	Left	Right	Left	Right	Left	Right	Left	Right
		Extra Left	Extra Right	Extra Left	Extra Right	Extra Left	Extra Right	Extra Left	Extra Right	Extra Left	Extra Right	Extra Left	Extra Right
STRETCH-AIR	LT1-MS4W3T-AL	Left	Right	Left	Right	Left	Right	Left	Right	Left	Right	Left	Right
		Extra Left	Extra Right	Extra Left	Extra Right	Extra Left	Extra Right	Extra Left	Extra Right	Extra Left	Extra Right	Extra Left	Extra Right
	LT1-MS5W3T-AL	Left	Right	Left	Right	Left	Right	Left	Right	Left	Right	Left	Right
		Extra Left	Extra Right	Extra Left	Extra Right	Extra Left	Extra Right	Extra Left	Extra Right	Extra Left	Extra Right	Extra Left	Extra Right
COMFORT-TEK	LT1-RF4W3T	Left	Right	Left	Right	Left	Right	Left	Right	Left	Right	Left	Right
		Extra Left	Extra Right	Extra Left	Extra Right	Extra Left	Extra Right	Extra Left	Extra Right	Extra Left	Extra Right	Extra Left	Extra Right
	LT1-RF5W3T	Left	Right	Left	Right	Left	Right	Left	Right	Left	Right	Left	Right
		Extra Left	Extra Right	Extra Left	Extra Right	Extra Left	Extra Right	Extra Left	Extra Right	Extra Left	Extra Right	Extra Left	Extra Right
STRETCH-AIR	LT1-RS4W3T	Left	Right	Left	Right	Left	Right	Left	Right	Left	Right	Left	Right
		Extra Left	Extra Right	Extra Left	Extra Right	Extra Left	Extra Right	Extra Left	Extra Right	Extra Left	Extra Right	Extra Left	Extra Right
	LT1-RS5W3T	Left	Right	Left	Right	Left	Right	Left	Right	Left	Right	Left	Right
		Extra Left	Extra Right	Extra Left	Extra Right	Extra Left	Extra Right	Extra Left	Extra Right	Extra Left	Extra Right	Extra Left	Extra Right
COMFORT-TEK	LT1-RF4W3T-AL	Left	Right	Left	Right	Left	Right	Left	Right	Left	Right	Left	Right
		Extra Left	Extra Right	Extra Left	Extra Right	Extra Left	Extra Right	Extra Left	Extra Right	Extra Left	Extra Right	Extra Left	Extra Right
	LT1-RF5W3T-AL	Left	Right	Left	Right	Left	Right	Left	Right	Left	Right	Left	Right
		Extra Left	Extra Right	Extra Left	Extra Right	Extra Left	Extra Right	Extra Left	Extra Right	Extra Left	Extra Right	Extra Left	Extra Right
STRETCH-AIR	LT1-RS4W3T-AL	Left	Right	Left	Right	Left	Right	Left	Right	Left	Right	Left	Right
		Extra Left	Extra Right	Extra Left	Extra Right	Extra Left	Extra Right	Extra Left	Extra Right	Extra Left	Extra Right	Extra Left	Extra Right
	LT1-RS5W3T-AL	Left	Right	Left	Right	Left	Right	Left	Right	Left	Right	Left	Right
		Extra Left	Extra Right	Extra Left	Extra Right	Extra Left	Extra Right	Extra Left	Extra Right	Extra Left	Extra Right	Extra Left	Extra Right

4 LATERAL TRUNK SUPPORT & HARDWARE Continued

Optional

4.2 LATERAL TRUNK SUPPORT HARDWARE

Select a set of hardware below (Section A). Extra links (Section B) may be selected to add 1" of additional depth and adjustability.

A) SWING-AWAY

UPCHARGE APPLIES

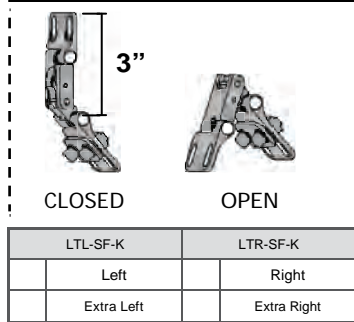

RIGID

UPCHARGE APPLIES

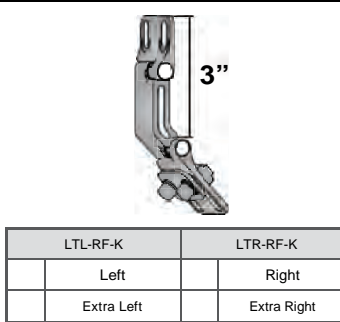

B) EXTRA LINKS

UPCHARGE APPLIES

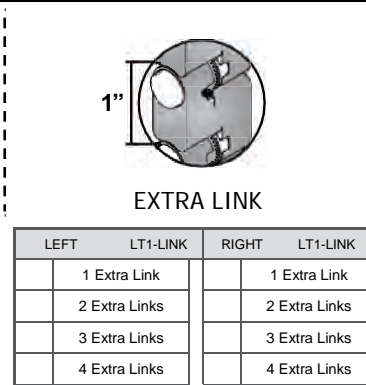

Both hardware styles in Section A are width adjustable.

4.3 PROTECTIVE COVER (OPTIONAL)

PROTECTIVE LATERAL HARDWARE COVER

UPCHARGE APPLIES

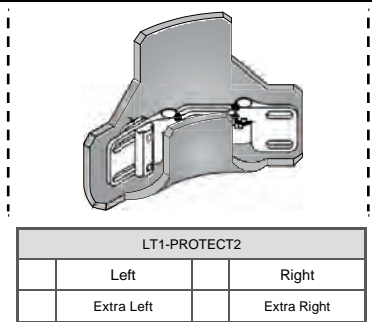

Cover wraps around hardware and closes with hook and loop attachment.

5 BODILINK HEAD SUPPORT & HARDWARE

Optional

5.1 HEAD SUPPORT PAD STYLE

UPCHARGE APPLIES

Length (L) refers to the actual size dimension of the support from bottom to top edge.

W		Pad Firmness	
L	6W x 3½L	Soft	BL-HSP1-6W3L
		Extra Soft	BL-HSP2-6W3L
L	8W x 4L	Soft	BL-HSP1-8W4L
		Extra Soft	BL-HSP2-8W4L
L	10W x 5L with adjustable wings	Soft	BL-HSP1-10W5L
		Extra Soft	BL-HSP2-10W5L
L	14W x 5L with adjustable wings	Soft	BL-HSP1-14W5L
		Extra Soft	BL-HSP2-14W5L
L	18W x 5L with adjustable wings	Soft	BL-HSP1-18W5L
		Extra Soft	BL-HSP2-18W5L
W			

5.2 PAD COVER MATERIAL

 COMFORT-TEK STRETCH-AIR 	FOR SKIN PROTECTION & SHEAR REDUCTION. NOT FLUID RESISTANT.
	FOR FLUID PROTECTION & AN EASILY CLEANED SURFACE.
	FOR AIR TRANSMISSION & HEAT DISSIPATION.
	GlideWear® (GLIDEWEAR)
	Comfort-Tek (COMFORT-TEK)
	Stretch-Air (STRETCH-AIR)

5.3

HEAD SUPPORT HARDWARE

BodiLink Head Support not available for 10"L Back Supports

HEAD SUPPORT BRACKET & HARDWARE UPCHARGE APPLIES

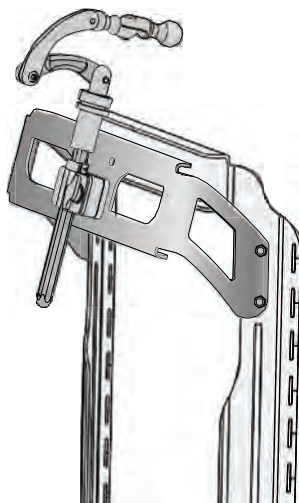

Required when using COMPASS® 4 hardware (2 or 4 POINT)

HEAD SUPPORT BRACKET ONLY* UPCHARGE APPLIES

*Purchase required when using a non-Comfort Company head support with COMPASS® 4 (2 or 4 POINT) Hardware.

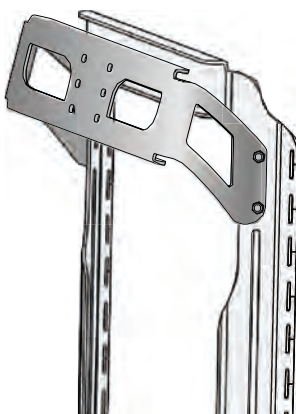

HEAD SUPPORT HARDWARE UPCHARGE APPLIES

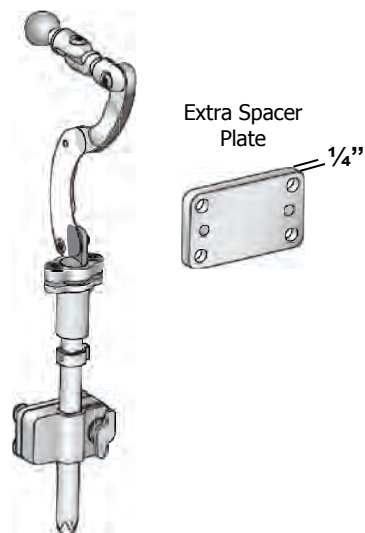

	14W Bracket and Hardware (BL-HSH-FX-AR14W)
	16W Bracket and Hardware (BL-HSH-FX-AR16W)
	18W Bracket and Hardware (BL-HSH-FX-AR18W)
	20W Bracket and Hardware (BL-HSH-FX-AR20W)

	14W Bracket Only (HSH-AR14W)
	16W Bracket Only (HSH-AR16W)
	18W Bracket Only (HSH-AR18W)
	20W Bracket Only (HSH-AR20W)

	Removable Hardware* (BL-HSH-FX)
	Extra Spacer Plate (BL-HSH-SPCR)

*Only available for Acta-Relief™ when using COMPASS® POWER MOUNT Hardware